

THE INFORMATION CONTAINED HEREIN IS CONFIDENTIAL AND NOT FOR PUBLICATION. BEING THE PROPERTY OF NNE PHARMAPLAN INDIA LIMITED, THE INFORMATION IS ISSUED ON THE UNDERSTANDING THAT NO PART THERE OF SHALL BE COPIED OR COMMUNICATED TO A THIRD PARTY WITHOUT AUTHORISATION IN WRITING FROM NNE PHARMAPLAN INDIA LIMITED.

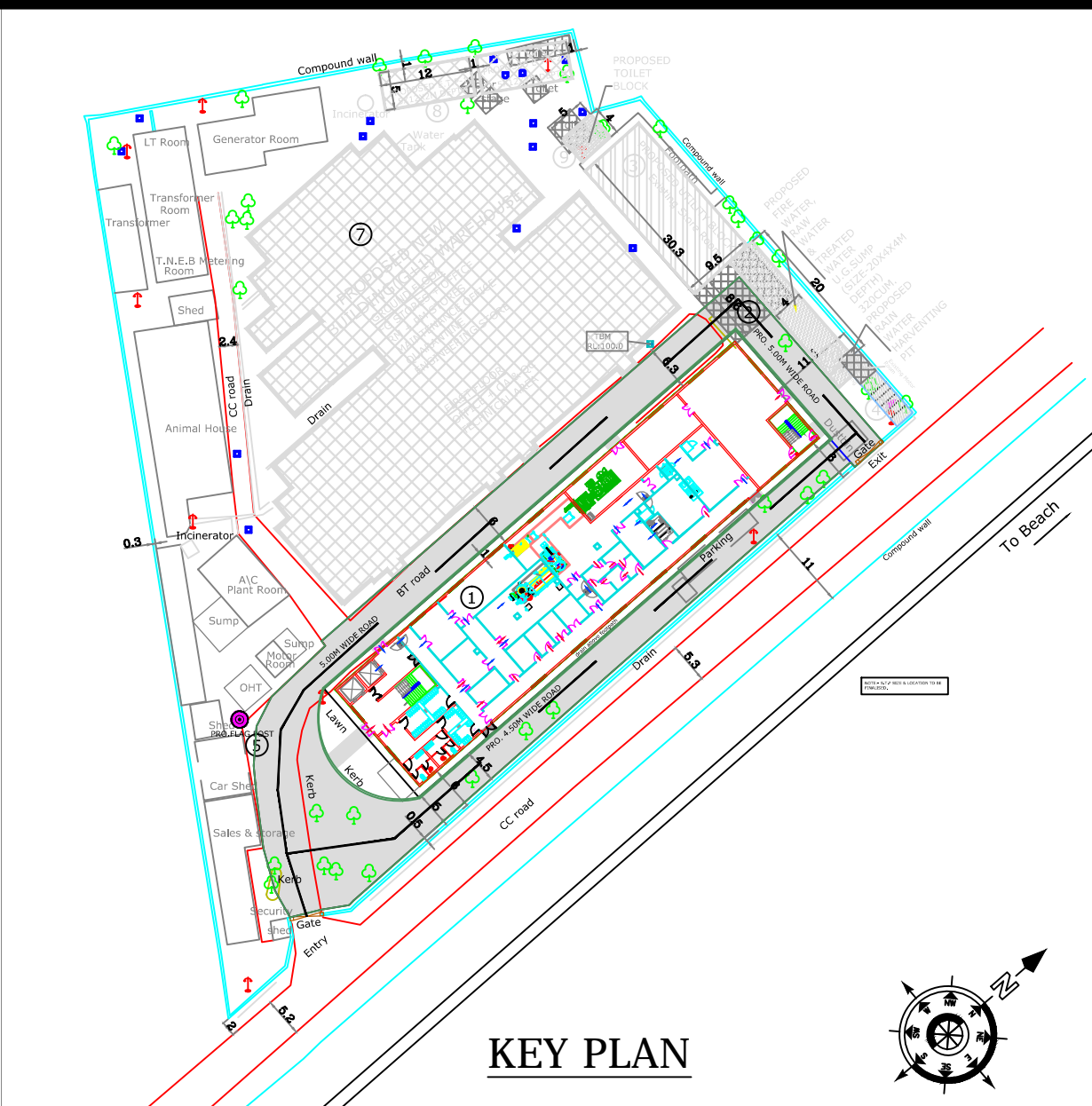
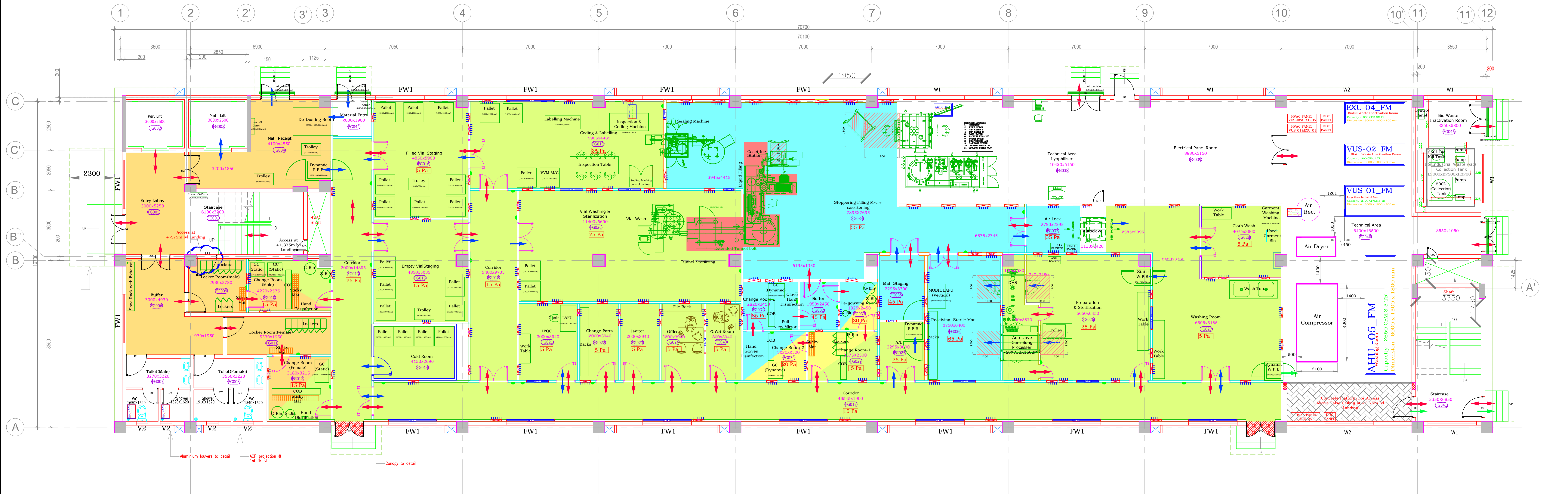

GROUND FLOOR PLAN @ +0.450 M Lvl.

SCHEDULE OF DOOR				
REF.	WIDTH	LINTEL	DESCRIPTION	QTY
DT	750	2100	SINGLE LEAF DOOR (TOILETS)	--
D1	1000	2100	SINGLE LEAF DOOR	--
D2	1500	2100	DOUBLE LEAF DOOR	--
D3	1200	2100	DOUBLE LEAF DOOR	--
ED	1500	2100	EMERGENCY EXIT DOOR (FIRE DOOR)	--
MD	500	1500	MAINTAINENCE DOOR	--

SCHEDULE OF VIEW PANEL/WINDOWS						
REF.	WIDTH	HEIGHT	CILL	LINTEL	DESCRIPTION	QTY.
FW1	2500	1100	1000	2100	DOUBLE GLASS VIEW PANEL FLUSHED BOTH SIDE WINDOW OPENABLE/SLIDING	--
W1	2500	1100	1000	2100	WINDOW OPENABLE/SLIDING WITH LOUVERS	--
W2	2500	1100	1000	2100	WINDOW OPENABLE/SLIDING WITH LOUVERS GLASS	--
V1	2000	600	1500	2100	VENTILATOR WITH LOUVERS GLASS	--
V2	600	600	1500	2100	VENTILATOR WITH LOUVERS GLASS	--

LEGEND

SYMBOL	DESCRIPTION
	Equipments/Furnitures
	Modular Panels
	Civil Wall
	Modular Door
	Modular View Panel
	Emergency Breakable View Glass
	Return Air Riser
	Magnehelic Gauge
	Garment Cubicle
	Cross Over Bench
	Wall Mounted Passbox
	Floor Mounted Passbox
	Bio Safety Cabinet
	Laminar Air Flow Unit
	Dry Heat Sterilizer

LEGEND

SYMBOL	DESCRIPTION
	CLASS - 'A'
	Unidirectional Air Flow (LAF)
	CLASS - 'B'
	CLASS - 'C'
	CLASS - 'D'
	CLASS - 'E'

LEGEND

SYMBOL	DESCRIPTION
	PERSONNEL FLOW
	MATERIAL FLOW
	BSL WASTE
	INACTIVATED WASTE

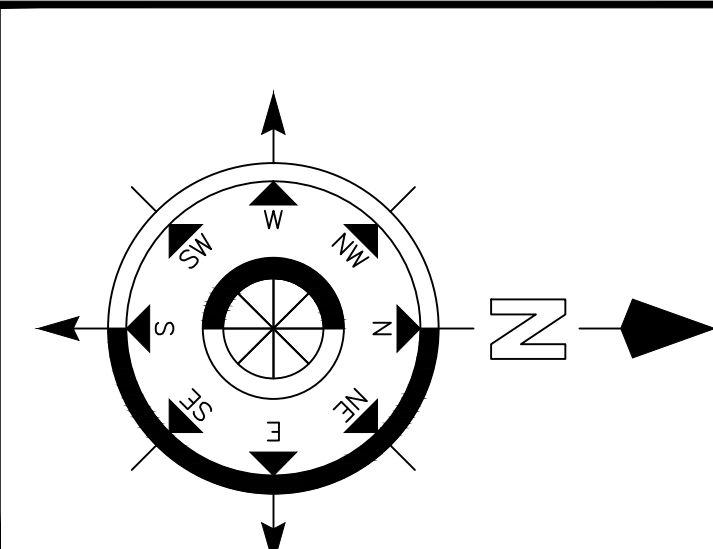

10	01.04.2013	SAPL	NVNG	LAF Above Sealing Machine Removed As Per MOM Dated 28.03.2013			
09	12.02.2013	RKVR	SLMU	Air compressor relocated from Utility block to the ground floor of main block, technical area(FG040). HVAC Electrical sub panels relocated.			
08	04.02.2013	PJNJ	NVNG	Cold room reduced & Hand Disinfection (FG010),(FG012) Added & D bin (FG029)added, G bin (FG033) removed.			
07	09.11.2012	PJNJ	NVNG	<ul style="list-style-type: none"><li>Receiving Sterile Mat. (FG036) Mobile LAF (Vertical) added</li><li>PAL (FG044) Room Removed</li><li>MAL (FG045) Room Removed</li></ul> Autoclave in Class D Area Laf Added. Differential pressure revised in room(FG018,FG019,FG020).			
06	19.10.2012	PJNJ	PMAY	<ul style="list-style-type: none"><li>HLL revised as per MOM Date (11.10.2012) :</li><li>Janitor Room (FG023) Vacuum Cleaner Removed</li><li>Cloth wash (FG028) Dryer Removed</li><li>Bio Waste Inactivation Room (FG046) Chemical Inactivation Tanks Removed</li></ul> Lyophilizer & filling machine revised , De-cont. autoclave shifted towards class B. Coding & Labeling room reduced to incorporate the sealing machine.			
Rev.	Date	Changed	Checked	Kind of revision	No. Of Prints	Date	Issued To
File name :					<div>nne pharma<span style="font-size: 0.8em;">plan</span><sup>®</sup></div> <div>NNE Pharmaplan India Limited</div> <div># 12, Achiah Shetty Layout, Bangalore - 560 080., INDIA.</div>		
Originated From Drg. No : NPI/110729/.....-Rev 00 [Option -00] Dt. 00.00.00							
Project: BCG VACCINES LABORATORY, GUINDY, CHENNAI		Project No.: 110729					
HLL LIFECARE LIMITED		Location CHENNAI					
Description:					Date	Name	
BCG VACCINE FORMULATION MANUFACTURING BLOCK PROPOSED GROUND FLOOR LAYOUT PLAN					Drawn	10.02.2012	PJNJ
					Checked	10.02.2012	SLMU/NVNG
					Approved	10.02.2012	NARP
					Scale-1:100	Units : mm	Size : A1
					Drawing no:	NPI/110729/LYT(GEN)/FG-01	
					Rev	10	